

FIVE STAR

P R O P E R T Y



The Sycamore, Plot 12 Greendale Gardens, Hucknall, Nottinghamshire, NG15 6EP

MODERN TOWN HOUSE - 3 BEDROOMS - 2 BATHROOMS - DINING KITCHEN - LOUNGE - INTEGRAL GARAGE - DRIVEWAY - ENCLOSED GARDEN - SOUGHT AFTER LOCATION - CONTACT TO VIEW.

- Modern 3 Bed Townhouse
- Kitchen/Diner & Lounge
- Two Modern Bathrooms
- Garage & Driveway
- Popular Location
- EPC: TBC

£229,950

GROUND FLOOR
APPROX. 42.8 SQ. METRES

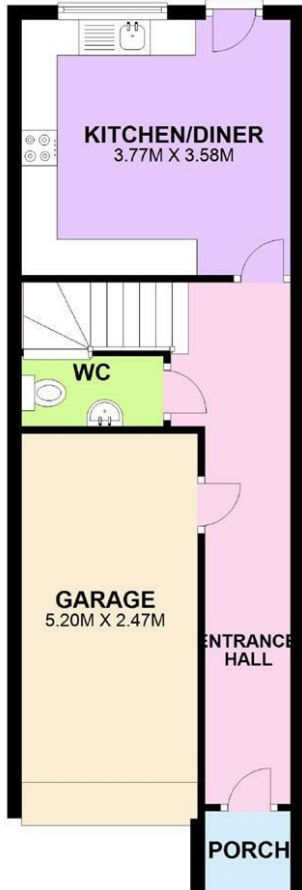

FIRST FLOOR
APPROX. 41.1 SQ. METRES

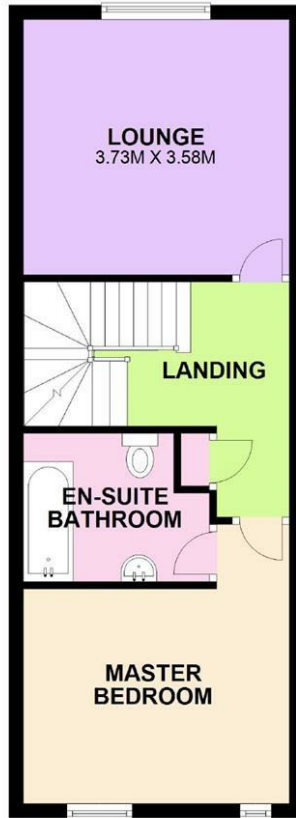

SECOND FLOOR
APPROX. 27.8 SQ. METRES



TOTAL AREA: APPROX. 111.6 SQ. METRES

Energy Efficiency Rating		Current	Potential
Very energy efficient - lower running costs			
(92 plus) A			
(81-91) B			
(69-80) C			
(55-68) D			
(39-54) E			
(21-38) F			
(1-20) G			
Not energy efficient - higher running costs			
England & Wales	EU Directive 2002/91/EC		

Environmental Impact (CO ₂) Rating		Current	Potential
Very environmentally friendly - lower CO ₂ emissions			
(92 plus) A			
(81-91) B			
(69-80) C			
(55-68) D			
(39-54) E			
(21-38) F			
(1-20) G			
Not environmentally friendly - higher CO ₂ emissions			
England & Wales	EU Directive 2002/91/EC		